

Modular leveling feet

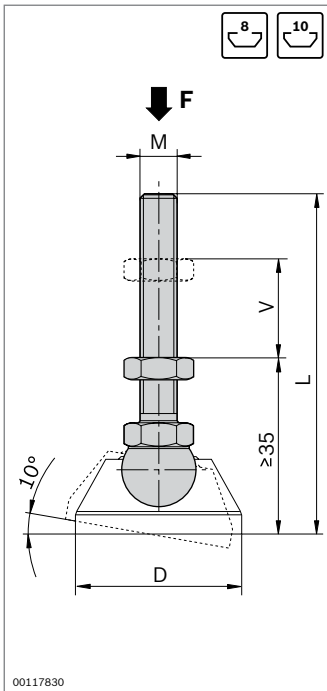

- ▶ Leveling feet for compensating irregularities in the floor up to 10°
 - Modular system, various combinations possible
 - Spindles and base plates can be combined as desired
 - Base plates with screw hole for simple screw fitting to the floor
- ▶ The damping plate prevents the transfer of vibrations and allows a defined conduction of voltages via a set of grounding components (p. 17-2)
- ▶ Profile finishing: thread M in central hole

Accessories: bearing ring (p. 6-16)



Spindle	F (N)	M	L (mm)	V (mm)	ESD	No.
Stainless steel	10000	M8	75	20		20 3 842 536 811
	20000	M12	85	30		20 3 842 536 812
	20000	M12	145	80		20 3 842 537 223
	20000	M12	200	135		20 3 842 537 225
	30000	M16	85	20		20 3 842 537 227
	30000	M16	145	80		20 3 842 537 229
	30000	M16	200	135		20 3 842 537 231
	steel; galvanized	10000	M8	75	20	
20000		M12	85	30		20 3 842 537 222
20000		M12	145	80		20 3 842 537 224
20000		M12	200	135		20 3 842 537 226
30000		M16	85	20		20 3 842 537 228
30000		M16	145	80		20 3 842 537 230
30000		M16	200	135		20 3 842 537 232

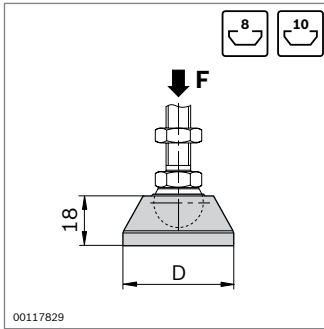

Base plate	F (N)	D (mm)	ESD	No.
Stainless steel	20000	29	▲	20 3 842 536 694
	30000	39	▲	20 3 842 536 695
	30000	44	▲	20 3 842 536 696
	30000	59	▲	20 3 842 538 673
	30000	79	▲	20 3 842 537 206
diecast zinc, black powder coating	20000	29		20 3 842 538 674
	30000	39		20 3 842 538 675
	30000	44		20 3 842 538 676
	30000	59		20 3 842 538 677
	30000	79		20 3 842 538 678
PA; black	5000	29		20 3 842 538 832
	9000	39		20 3 842 538 833
	9000	44		20 3 842 538 834
	9000	59		20 3 842 538 835
	9000	79		20 3 842 538 836

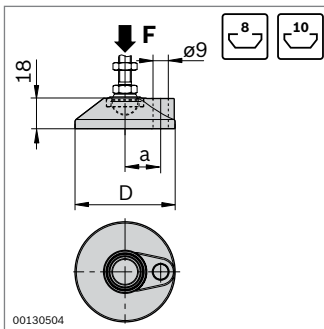

Base plate with screw hole	F (N)	D (mm)	a (mm)	No.
	30000	59	21	20 3 842 538 932
	30000	79	31	20 3 842 538 934

Material: diecast zinc, black powder coating

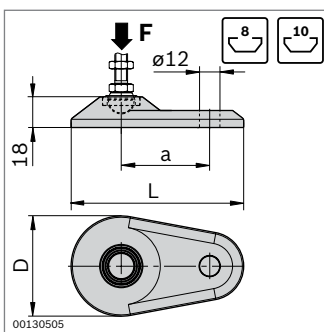

Oval base plate with screw hole	F (N)	D (mm)	a (mm)	L (mm)	No.
	30000	59	52	100	20 3 842 538 679
	30000	79	65	130	20 3 842 538 680

Material: diecast zinc, black powder coating

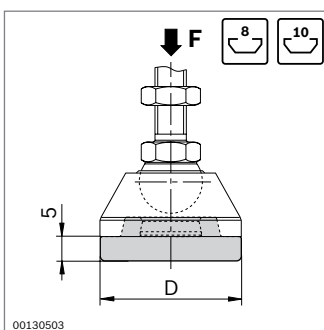

Damping plate	F (N)	D (mm)	No.
	1100	29	20 3 842 538 555
	1600	39	20 3 842 538 556
	2000	44	20 3 842 538 557
	2500	59	20 3 842 538 558
	2800	79	20 3 842 538 559

Material: PUR, black